



**FEATURES**

- 6.5" dynamic cone speaker designed to offer balanced response for music & speech.
- 6W transformer with multi tapping applications.
- Coil spring catch method allows the panel to be quickly and easily attached to the speaker.
- Hard speaker cover protects the speaker from dust and impacts.
- The speaker's high-impact styrene resin material corresponds to incombustibility grade UL94V-0, and maintains the speaker's self-extinguishing capabilities to ensure excellent flame-retardant characteristics.
- Input transformer is incorporated for high efficiency of PA use.
- ABS resin frame and aluminum grille (standard package) and the panel & grille can be custom-made from other material and colour.

**SPECIFICATIONS**

Model No.	CS-405A
Rated Input	6W
Max Input	9W
Impedence	1.7 kΩ, 3.3 kΩ
Power Taps	100V: 6 W, 3W; 70V: 3 W, 1.5W
SPL(1W / 1m)	92dB
Max SPL (Rated / 1m)	99dB
Frequency Response(-10dB)	100Hz~18kHz
Dispersion (4kHz / 1kHz)	90° / 120°
Power Selection Way	3-core cable: Red-1.7 kΩ, White-3.3 kΩ, Black-COM
Material	Panel & Cover: ABS; Grille: steel
Color	White
Temperature / Humidity	-20°C ~ 55°C; <95%
Speaker Component	6.5" dynamic cone speaker
Dimensions	Ø227 x 110H mm
Mounting Hole	Ø200 x 120H mm, Max ceiling thickness: 50mm
Weight	1kg
Mounting	Spring Catch

**PANEL DRAWING & DIMENSIONS**

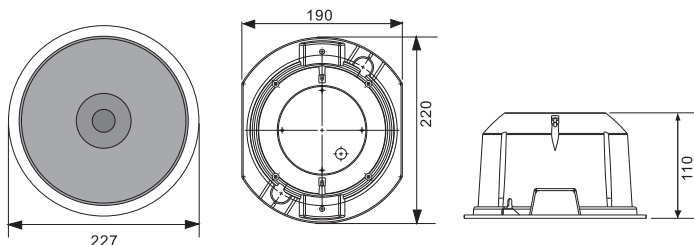

**INSTALLATION**

Step 1. Make a hole with the following diameter in the ceiling as picture 1 shows.

Picture 1

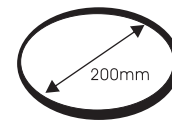

Step 2. Connect the speaker cables to the output from amplifier or PA system. Parallel-branch connections can be made.

Step 3. Mount the speaker in the ceiling as picture 2 shows. Usable ceiling boards are those which are up to 50 mm thick.

Picture 2

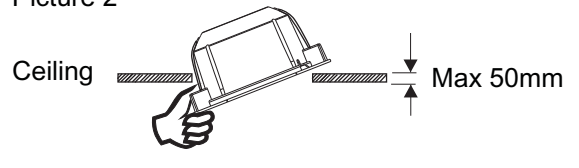

Step 4. Connect springs to the speaker panel to attach it as picture 3 shows.

Picture 3

