

Thinuna



FS-Q5 / FS-Q6

Two way Indoor/Outdoor Speakers

Installation and Operation Manual

Introduction

Congratulations on your purchase of Thinuna FS-Q5 or FS-Q6 2 way indoor/outdoor speakers! These speakers are the result of many years of research and development dedicated to producing high quality products for home audio and audio/video systems.

This manual contains features, setup recommendations and specifications for the Thinuna FS-Q5 and FS-Q6 fashion indoor/outdoor speakers. It is recommended you thoroughly read through the material contained in this manual before connecting your speakers. This will ensure you have a good understanding of how to setup your speakers for optimum performance and allow for years of listening enjoyment.

Parts Guide

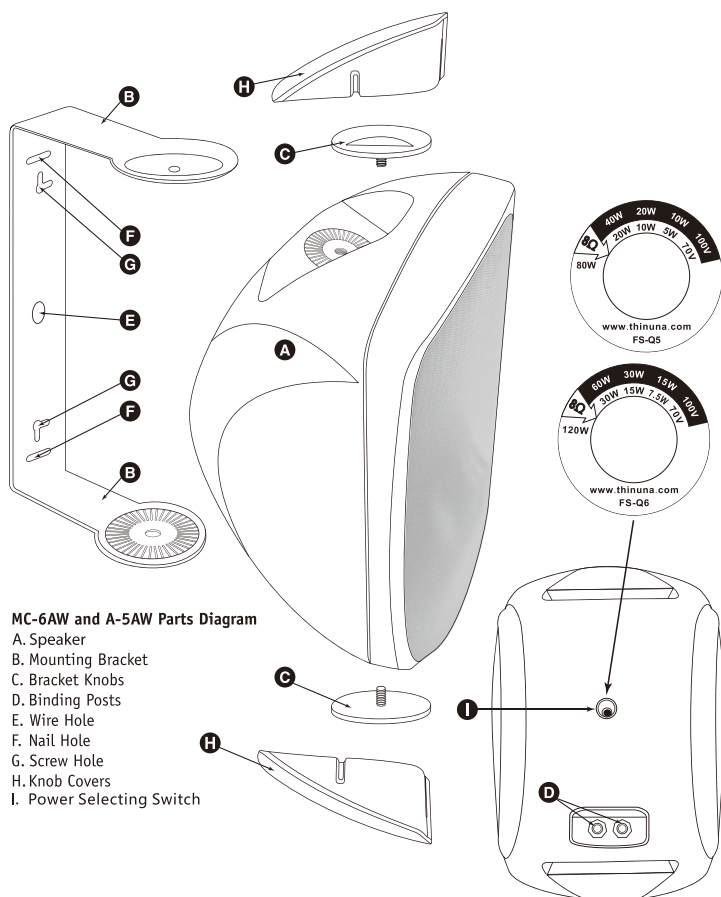

Features

Thinuna FS-Q series universal surface speakers are compact systems with rugged, molded Cast Poly-Resin housing and Aluminum grille to ensure its durability and sound quality.

This series of speakers rated to IP67. All of our products have taken the waterproof test before selling. Designed for widely-using in outdoor applications which need good sound quality: like commercial pedestrian street, pub street, villa, swimming pool, golf course, and playground. It can also have excellent performance in use of indoor: conference room, boardroom, and multi-functional room.

They are suitable for outdoor applications and indoor applications is good as well.

Matching transformer with multi tapings for 100/70V/8Ω input, offers versatility, and it is capable for profession audio and public address applications.

We offer black and white alternative color or other spraying colors which are concerted to decoration, and it is fit for different environment.

Humanizing design mounting bracket makes installation easy and fast, saving installation cost and time. You can also change the speaker's any angle in order to control sound directivity.

- * The top weatherproof speaker of Thinuna.
- * Water protected to IEC529 IP67.
- * Excellent sound quality.
- * Weatherproof housing design for pro-audio and commercial market.
- * Excellent aluminum tweeter and woofer.
- * Tremble is permeable, bright, soft and comfortable.
- * Powerful bass, also massive and strong.
- * Have 100/70V and 8Ω selectable switch.
- * Matching transformer with multi tapings for 100/70V input.
- * Available in black and white of the Cast Poly-Resin enclosures and Aluminum grille.
- * Attractive cabinet design for improved sound directivity.
- * Very high quality 2 way speaker system.
- * U type steel bracket include for fast and easy installation. (Also optional other bracket)

Speaker Placement

Establish where the most likely or average listening area will be. Ideally, speakers should be placed on either side of the targeted listening area with at least 8 to 10-feet of total separation. For best performance, try to leave at least 4 to 5-feet of distance between each speaker and the listening area. The distance from the listening area to each speaker should be close to the distance that separates the two main speakers. Angling the speakers inward towards the listening position may give a more spacious and realistic sound stage. Experiment with speaker placement to determine which location offers the best overall sound.

Placing the speakers in a corner or under an eave will provide reinforcement for the bass frequencies, resulting in higher bass output. Placing the speakers away from any corners or walls will provide the least amount of reinforcement, resulting in lower bass output.

Speaker Placement

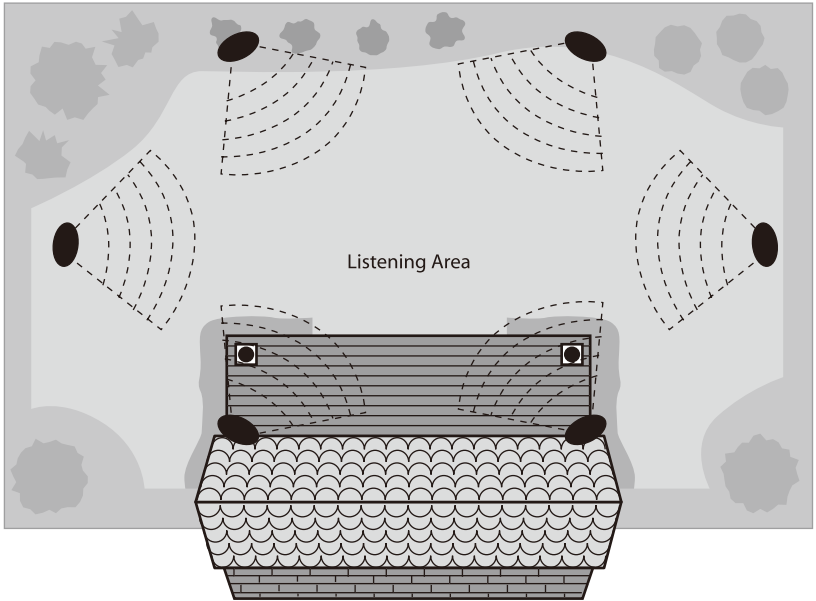

Installation

The bracket has the ability to be mounted a variety of different ways. It may be mounted with either nails or screws, horizontally or vertically. There is a hole in the center of the bracket to allow speaker wire through so it may be properly attached to the speaker. The cabinet back has a female M6x1.0mm thread for an optional swivel bracket mount.

If working properly, insert the knob covers to complete the installation.

Mounting and Connections

For the following instructions you may need to refer to the Parts Guide section located on the first page of this manual.

1. The speaker may be mounted either horizontally or vertically. Hold the bracket against the mounting surface, so you can mark the locations of the mounting holes, and the wire hole.
2. Drill corresponding pilot holes for the mounting screws or nails and a hole large enough for the speaker wire to pass through.
3. Pull the speaker wire through the hole and through the bracket, aligning the bracket with the pilot holes.
4. Use hardware to attach the bracket to the mounting surface.

Installation (continued)

5. Use the bracket knobs to attach the speaker to the bracket, being careful to not tighten the knobs until the desired location is attained; this will allow the speaker to be angled slightly so the rear binding posts are accessible.
6. Connect one wire to the black terminal and one to the red terminal, paying close attention to the markings on the wire for proper polarity. Each speaker must be connected to the amplifier in the same way.

NOTE: Before proceeding, if you are unfamiliar with running speaker wires and are uncomfortable with this type of installation, please contact a qualified installation professional.

When all connections have been made and double-checked, turn on your receiver/amplifier and test for proper operation by walking around the listening area to ensure sound is coming from all connected speakers. If a speaker is not working correctly, please refer to the troubleshooting section of this manual. If working properly insert knob covers to complete installation.

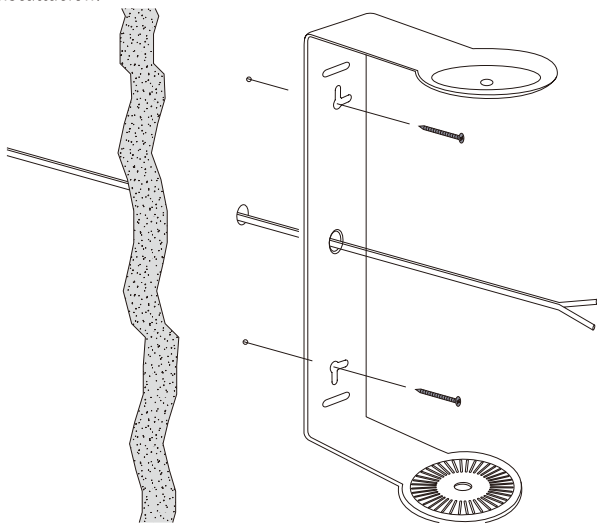

Operation

When using the 8ohms input (connected to a low impedance amplifier), an amplifier with an output power rating of 10~130 watts per channel is recommended. This will help to protect the speaker from being under or over driven, which may cause permanent damage. When using the 100V or 70V input (connected to a high impedance amplifier), just make sure the total speaker power is not exceed the amplifier's rated power.

When listening to the speakers outdoors, keep in mind that there are very few walls to reinforce the sound. Therefore, be careful not to drive the speakers beyond their capabilities when trying to obtain a desired volume level. You will be able to determine audibly when the speaker is being overdriven by the "break up" or distorted sound that will be coming from the speaker.

Troubleshooting

Situation:	Probable Cause:	Solution:
No sound from speakers.	Speaker wire not connected. Speaker selector on amplifier is not on.	Make sure wire is connected at both the speaker and the amplifier observing proper polarity. Activate proper selector on amplifier.
No sound from one speaker.	Balance control on receiver or pre-amp is not centered. Speaker wire not securely connected.	Place balance control in the center. Check all connections at amplifier and speakers.
Very little bass and/or imaging	Speakers are wired out of phase.	Check entire system for proper polarity and make adjustments as necessary

Specifications

Model No.	FS-Q5 B/W	FS-Q6 B/W
Rated Input	40W@100V; 80W@8Ω	60W@100V; 120W@8Ω
Max Input	60W@100V; 160W@8Ω	90W@100V; 240W@8Ω
High Impedance	250Ω, 500Ω, 1kΩ	167Ω, 333Ω, 666Ω
Power Taps	100V: 40 W, 20 W, 10W 70V: 20 W, 10 W, 5W	100V: 60 W, 30 W, 15W 70V: 30 W, 15 W, 7.5W
SPL (1W / 1m)	88dB	89dB
MAX SPL (Rated / 1m)	104dB@100/70V; 107dB@8Ω	107dB@100/70V; 109dB@8Ω
Frequency Response(-10dB)	59Hz~20kHz	54Hz~20kHz
Crossover Slope	12dB / Octave	
Dispersion (4kHz / 1kHz)	125° / 190°	80° / 190°
Power Selecting Way	Rotating Selection Switch	
Material	Housing: Cast Poly-Resin; Grille: Aluminum Micro -perf	
Color	FS-Q5B, Q6B: Black; FS -Q5W, Q6W: White	
Temperature / Humidity	-30°C ~ 60°C; <95%	
Water Protection	IEC529 IP67	
Speaker Component	5.25" Aluminum Cone Woofer + 1" Aluminum Dome Tweeter	6.5" Aluminum Cone Woofer + 1" Aluminum Dome Tweeter
Dimensions	190(W) x 279(H) x 184(D)	228(W) x 324(H) x 210(D)
Weight	3.5kg	5kg

Warranty

Thinuna FS-Q5 and FS-Q6 fashion indoor/outdoor speaker is covered by a limited warranty against defects in materials and workmanship for a period of special 3 years from the original date of purchase. This warranty is provided by the authorized Thinuna audio dealer where the speakers were purchased. Warranty repair will be performed only when your purchase receipt is presented as proof of ownership and date of purchase. Defective parts will be repaired or replaced without charge by your dealer's store or the location designated by your dealer authorized to service Thinuna tech products. Charges for unauthorized service and transportation cost are not reimbursable under this warranty. This warranty becomes void if the product has been damaged by alteration, misuse or neglect. Thinuna tech assumes no liability for property damage or any other incidental or consequential damage whatsoever which may result from the failure of this product. Any and all warranties of merchantability and fitness implied by law are limited to the duration of this express warranty. Some states do not allow limitations on how long an implied warranty lasts, so the above limitations may not apply to you. Some states do not allow the exclusion or limitation of incidental or consequential damages, so the above limitation or exclusion may not apply to you.



www.thinuna.com